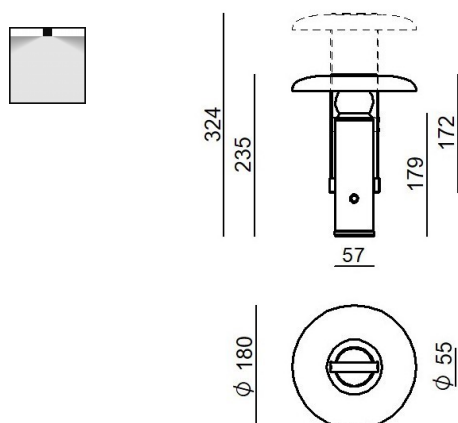

Table Lamps | 12 topLED 2.5 W DC | CRI 90
9650

EAC CE RoHS C.C. IP20



Technical data	
Type	Table Lamps
Installation position	Floor
Installation environment	Indoor
Light Source	LED
Optics	Diffused
Light emission direction	downward
Nominal power	2.5 W DC
Source lumens 1700K	200 lm
Temperatura colore minima	1700 K
Source lumens 4000K	370 lm
Temperatura colore massima	4000 K
Colour rendering index	90 Ra
C.C. / C.V.	AC-DC
Safety class	2
IP	IP20
Glow wire test	650°
Direct mounting on normally flammable surfaces	Yes
CE	Yes
Dimmable article	Touch
Directional	No
Tilting	No
Walk-over	No
Drive-over	No
Cable included	Yes
Electric socket	Type C
Cable length	1 m
Resin potting	No
Type of light emission	Single emission
Net weight	0.780 Kg
Electrostatic discharge protection	No
Surge protection	No
CCT / Tone	4000 - 1700

Finishing casing	
Material	Aluminium
Colour	white
Processing	Coating
Finishing diffuser	
Material	PMMA
Colour	transparent
Finishing base	
Material	Aluminium
Colour	white
Processing	Coating



Table Lamps | 12 topLED 2.5 W DC | CRI 90 | Color temperature : 4000 K
9650

Single emission table lamps for indoor application. The dynamic white LED light source with a diffused light distribution is composed of 12 topLEDs with CCT of 1700k - 4000 K and a CRI 90.

The device body is made of aluminium and features a white finish, processed by means of coating; the diffuser is made of pmma. The ingress protection degree is IP20; the total weight is of 0.780 kg.

The total absorbed power is 2.5 W. The power supply cable is included and features a 1 m length.

The device features protection class II and can be floor-mounted.

Compliant with the EN 60598-1 standard and its specific provisions.

Illuminotechnical Features	
Delivered lumens	140 lm
Consumption	2,5 W
Luminaire efficacy	70 lm/W
Colour temperature	4000 K
Colour rendering index	90 Ra
Junction temperature (lighting fixture)	80
Standard Operating Ambient Temperature	25°C

LED Life / Failure Ratio	
L70 B20 C0 50000h (at Tj 115 Ta 25)	

UGR	
UGR axial	17.1
UGR transversal	16.3
X=4H Y=8H	S=0.25H
Reflection factor	70/50/20

OPTICAL	
C0/C180 optics	137°
Light distribution simmetry	Symmetrical

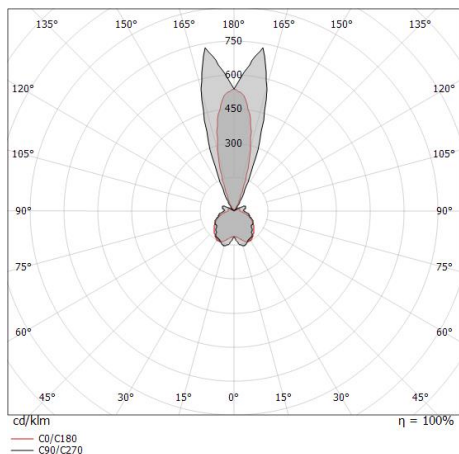

Distance [m]	Cone diameter [m]	Illuminance [lx]
0.5	2.51 2.59	E(0°) 64 E(C90) 2 E(C0) 2
1.0	5.03 5.18	E(0°) 16 E(C90) 1 E(C0) 0
1.5	7.54 7.77	E(0°) 7 E(C90) 0 E(C0) 0
2.0	10.05 10.37	E(0°) 4 E(C90) 0 E(C0) 0
2.5	12.56 12.96	E(0°) 3 E(C90) 0 E(C0) 0
3.0	15.08 15.55	E(0°) 2 E(C90) 0 E(C0) 0

— C0/C180 (Half-peak divergence: 137.8°)
— C90/C270 (Half-peak divergence: 136.6°)

Table Lamps | 12 topLED 2.5 W DC | CRI 90 | Color temperature : 1700 K

9650

Single emission table lamps for indoor application. The dynamic white LED light source with a diffused light distribution is composed of 12 topLEDs with CCT of 1700k - 4000 K and a CRI 90.

The device body is made of aluminium and features a white finish, processed by means of coating; the diffuser is made of pmma. The ingress protection degree is IP20; the total weight is of 0.780 kg.

The total absorbed power is 2.5 W. The power supply cable is included and features a 1 m length.

The device features protection class II and can be floor-mounted.

Compliant with the EN 60598-1 standard and its specific provisions.

Illuminotechnical Features	
Delivered lumens	99 lm
Consumption	2,5 W
Luminaire efficacy	49 lm/W
Colour temperature	1700 K
Colour rendering index	90 Ra
Junction temperature (lighting fixture)	80
Standard Operating Ambient Temperature	25°C

LED Life / Failure Ratio	
L70 B20 C0 50000h (at Tj 115 Ta 25)	

UGR	
UGR axial	15.9
UGR transversal	15
X=4H Y=8H	S=0.25H
Reflection factor	70/50/20

OPTICAL	
C0/C180 optics	134°
Light distribution simmetry	Symmetrical

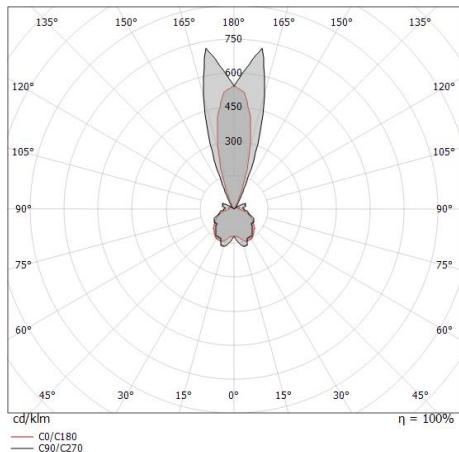

Distance [m]	Cone diameter [m]	Illuminance [lx]
0.5	2.37 2.34	E(0°) 48 E(C90) 2 E(C0) 2
1.0	4.73 4.69	E(0°) 12 E(C90) 0 E(C0) 0
1.5	7.10 7.03	E(0°) 5 E(C90) 0 E(C0) 0
2.0	9.47 9.38	E(0°) 3 E(C90) 0 E(C0) 0
2.5	11.84 11.72	E(0°) 2 E(C90) 0 E(C0) 0
3.0	14.20 14.07	E(0°) 1 E(C90) 0 E(C0) 0

Distance [m] Cone diameter [m] Illuminance [lx]

— C0/C180 (Half-peak divergence: 133.8°)
— C90/C270 (Half-peak divergence: 134.2°)